



PURPOSE BUILT APARTMENT with ALLOCATED COVERED PARKING, WEST FACING SUN TERRACE & NO ONWARD CHAIN! Boasting close to 800 Sq ft of internal living accommodation, this is an excellent opportunity to acquire a two-bedroom apartment located on the first floor of Blythswood, Jesmond. Situated on the corner of Osborne Road and Clayton Road, Blythswood is a purpose built block that was constructed by Banyard in the late 70's and is well placed to access the local shops, cafes and restaurants. Jesmond Metro Station is also only a short walk away, providing excellent access throughout the region.

The accommodation briefly comprises: communal entrance with lift access and private store cupboard, through to entrance hall with built in storage and shower room with WC; 22ft lounge/diner with dual aspect and picture windows out onto an enclosed sun terrace, kitchen, separate WC and two double bedrooms, the master with en-suite bathroom, large picture windows and fitted storage. Externally, the property offers an allocated private parking space along with visitors parking and lawned communal gardens. Double-glazed throughout, and available immediately, an early viewing comes highly recommended!

First Floor Apartment | 763 Sq ft (70.9m²) | Two Double Bedrooms | 22ft Lounge/Diner with Dual Aspect | Sun Terrace | Kitchen | En-Suite Bathroom | Shower Room | Allocated Covered Parking | Communal Gardens | Fantastic Location | No Onward Chain | Leasehold with 949 Years Remaining | Service Charge £2,160 Per Annum | Council Tax Band | EPC Rating: E

Offers Over £195,000

IMPORTANT NOTE: These particulars and the descriptions and measurements herein do not constitute representation and whilst every effort has been made to ensure accuracy, this cannot be guaranteed.

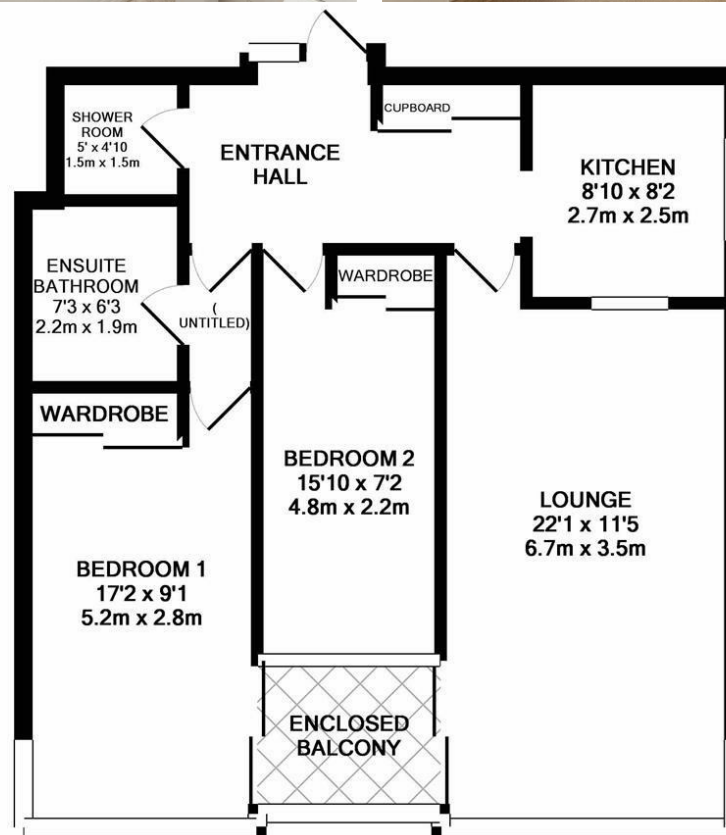

TOTAL APPROX. FLOOR AREA 763 SQ.FT. (70.9 SQ.M.)

Whilst every attempt has been made to ensure the accuracy of the floor plan contained here, measurements of doors, windows, rooms and any other items are approximate and no responsibility is taken for any error, omission, or mis-statement. This plan is for illustrative purposes only and should be used as such by any prospective purchaser. The services, systems and appliances shown have not been tested and no guarantee as to their operability or efficiency can be given
Made with Metropix ©2018

